

**Aviasafe GmbH**

**Headoffice** 60489 Frankfurt am Main/Germany  
Eschborner Land Str. 55

**Tel** +49 69 340 03 314

**Fax** +49 69 707 978 04

**Factory** DE 98597 Fambach Neue Wiese 2

**Tel** +49 368 482 764 70

info@aviasafe.de

www.aviasafe.de



- Designed with few mechanical parts, resulting in a more affordable price and allowing for longer maintenance intervals.
- Fully dimmable lights. The light output is variable, similar to a traditional halogen light, operating within the 2.8 A to 6.6 A range.
- Low protrusion, Style 3 inset light fixtures.
- The electronics are fully encapsulated.
- Optimized LED performance ensures there are no visual flickers.
- The Dome is designed with no negative slope in front of the prism.
- Built-in voltage surge and lightning protection.

**INSTALLATION**

Light fixture can be installed in 8-inch Shallow Base & Deep Base , or 12-inch bases by an Adaptor Ring.

*Refer to the user manual*

**ENVIRONMENTAL CONDITIONS**

**Temperature:** -45 °C to +55 °C / -49 °F to +131 °F

**Humidity:** Up to 100%

**DIMENSIONS & WEIGHT**

**Diameter:** 214 mm

**Depth:** 106 mm

**Weight:** 3.7 kg

**COMPLIANCE**

**ICAO** Annex 14 - Volume I

**EASA** CS-ADR-DSN

**FAA** AC150/5345-46 & EB No.67D

**IEC** TS 61827

**NATO** STANAG 3316

**CAA** CAP 168

**IAEE** TP312

**APPLICATIONS**

- Runway Centreline
- R.E.T.I.L

**FEATURES & BENEFITS**

- LED Unidirectional 8"
- Average LED life of 60,000 hours at full intensity but over 100,000 hours in typical operating conditions.
- Very low energy consumption compared to halogen lights, resulting in a lower range of CCRs and transformers.
- Low life cycle costs due to the long LED lifespan.
- Operates on 3-step or 5-step ferroresonant or thyristor CCRs.
- In compliance with FAA & EASA standards.
- Fully compatible with existing Airfield Lighting infrastructure. Installation on the same mounting device as most conventional lights for a straightforward replacement.
- IP68: Dust-tight and protected against submersion in water.



**COMPONENTS**

- 01. Dome (Upper Cover)
- 02. Prism Gasket
- 03. Prism
- 04. Prism Holder Gasket
- 05. Prism Holder
- 06. TIR (Lens)
- 07. LED PCB
- 08. LED Headsink
- 09. O-Ring for Dome
- 10. Lower Cover with Electronics
- 11. Lower Cover Gasket
- 12. Cable Gland
- 13. Air Valve
- 14. Plug

Refer to the user manual

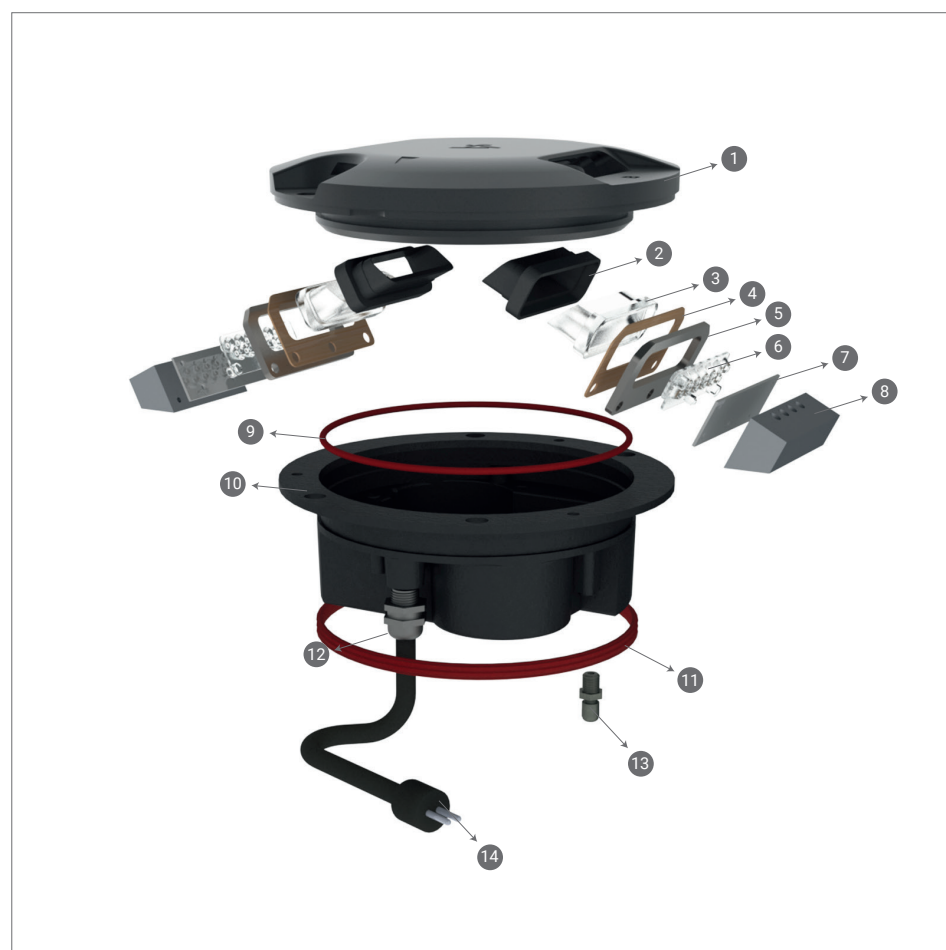

**PHOTOMETRIC PERFORMANCE**

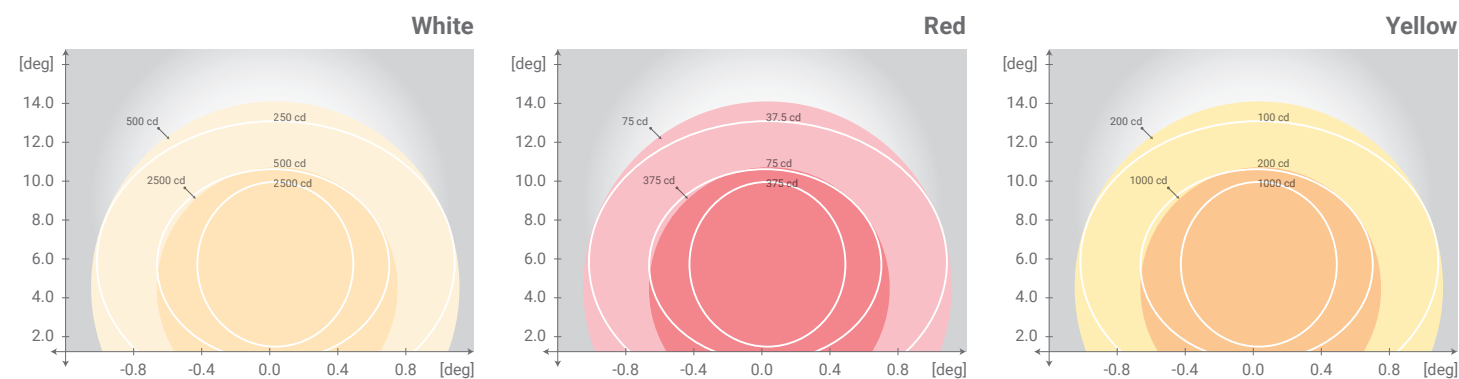

ELECTRICAL TABLE				
TYPE	Consumption at 6.6A		Power Factor	
	1 Plug	2 Plugs	2.8A	6.6A
Unidirectional Without Heater	16 VA	-	0.96	0.98
Unidirectional With Heater	36 VA	-	0.96	0.98
Bidirectional Without Heater	29 AV	32 AV	0.96	0.98
Bidirectional With Heater	49 AV	72 AV	0.96	0.98

**INSTALLATION SECTION**

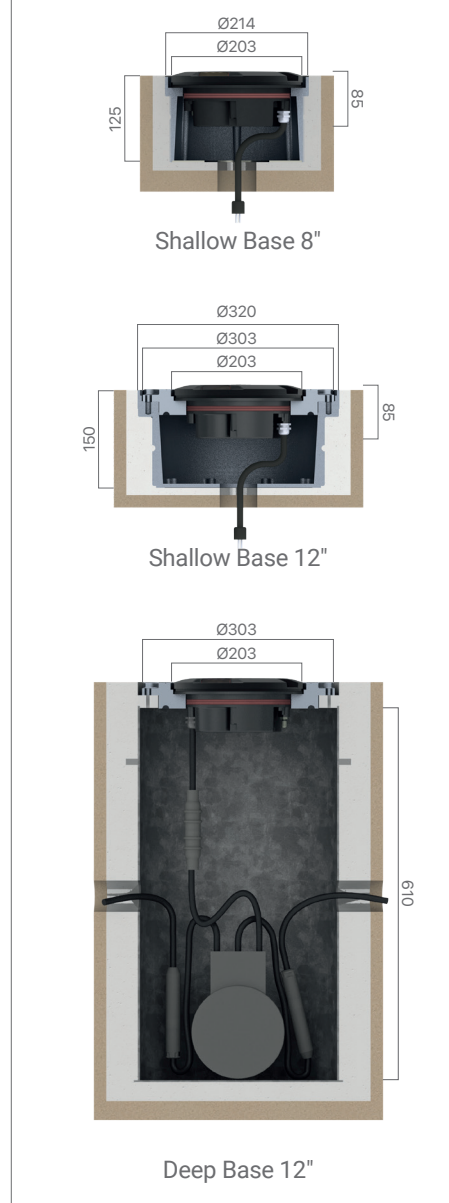

**IN-RC RC WW 1P N M H**

Inset Light Type For Runway Centerline

**Application**

- RC : Runway Centerline
- ET : Rapid Exit Taxiway Indicator (RETIL)

**Color (Left Side / Right Side)\***

- W : White
- G : Green
- R : Red
- Y : Yellow
- 0 : None ( Unidirectional )

**Cable & Connectors**

- 1P : One Plug
- 2P : Two Plugs

**Mounting Assembly**

- N : No mounting assembly
- R : with Adaptor Ring (12 - "8")

**Monitoring**

- M : with Monitoring
- Q : without Monitoring

**Heater**

- H : with Heater
- C : without Heater