



**MATERIALS AND FINISH**

- Body: Aluminum extrusions, panels, corner leg supports and mounting legs
- Panel: long-life polycarbonate, UV and abrasion resistant
- Stainless steel hardware

**DIMENSIONS**

- **Width:** 135 mm
- **Height:** 846 mm (Message Size 3)  
646 mm (Message 4)
- **Length (600-3000) mm:** { 641, 691, 741, 791, ..., 2941, 2991, 3041 } mm

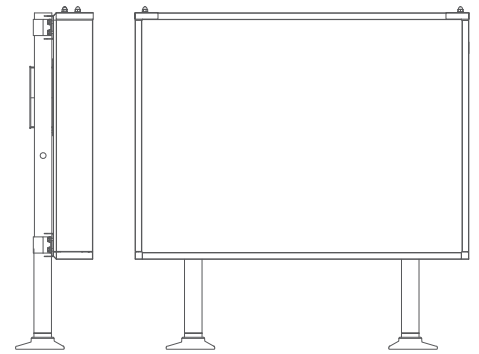

**COMPLIANCE**

- ICAO** Annex 14 - Volume I
- FAA** AC150/5345-46
- EASA** CS-ADR-DSN

**APPLICATIONS**

On civil or military airports as:

- Mandatory Instruction Signs
- Information Signs
- VOR Check Point Signs
- Runway Distance Remaining Signs
- Arresting Barrier Signs

**FEATURES & BENEFITS**

- Highly visible in all weather conditions
- Supplied fully assembled
- Special design features for ease of maintenance
- Extruded aluminum profile
- UV stabilized 4mm polycarbonate
- Weather-proof to IP54
- Temperature range of -°25C to +°55C
- Setting of panel character, intensity, evenness and chromaticity achieved ICAO Annex 14.
- Modular design for easy maintenance
- Excellent performance and lower energy consumption reduce the operation cost.
- Panel can be open to facilitate internal cleaning
- Tool-free front door open design
- Frangibility according to ICAO or FAA requirements

**CONSUMPTIONS**

Length	Power
600 - 900 mm	30W
950 - 1300 mm	40W
1350 - 1650 mm	50W
1700 - 1850 mm	60W
1900 - 2250 mm	70W
2300 - 2550 mm	80W
2600 - 2800 mm	90W
2850 - 3000 mm	100W

## COMPONENTS

01. Upper Cap
02. Upper Frame
03. Upper Cover
04. Side Frame
05. Face (Front Panel)
06. Glands & Switch
07. Back Plate
08. Led Bars
09. Lower Frame
10. Airfield Sign Board
11. Pole
12. Pole Holder
13. Base Plate
14. LED Holder

Refer to the relevant technical manual for the complete list of the available spare parts

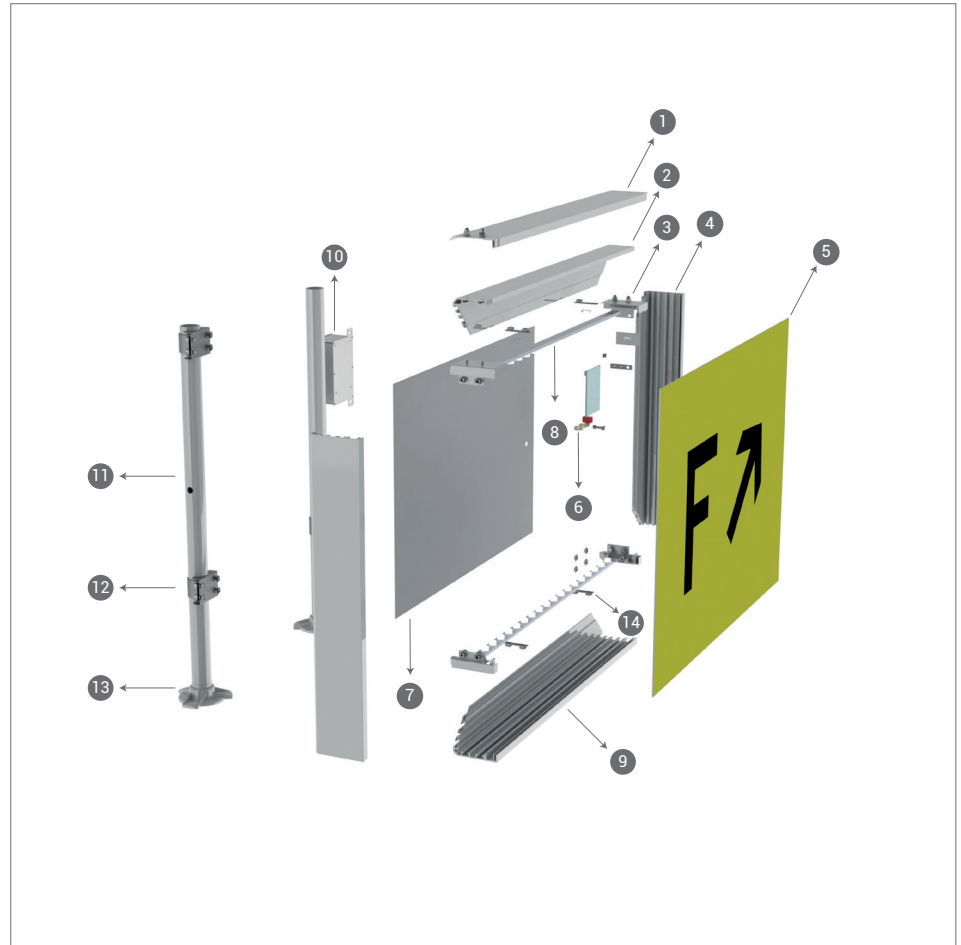

**AGS - 11 - 8 - I - U - A**

Basic P/N

**Length:** 600 - 3000 mm  
600 mm: 06 - 700 mm: 07 ..... 3000 mm: 30

**Height:** 600 or 800 mm  
600 mm: 6 - 800 mm: 8

**Illumination:**  
0= Not Illuminated  
1= LED Illuminated

U= Upper Cap  
S= Side Cap

**Supply Mode:**  
A= 6.6 A  
V= 220 V  
0= Not Illuminated



**Aviasafe GmbH**

**Headoffice** DE 60478 Frankfurt am Main/ Germany  
Frauenlob Str.8

**Tel** +49 69 970 863 97

**Fax** +49 69 707 978 04

**Factory** DE 98597 Fambach Neue Wiese 2

**Tel** +49 368 482 764 70