



- Fully dimmable light, the light output is like the curve of traditional halogen lights.
- Low protrusion, Style 3 inset light fixtures
- The electronics are fully encapsulated
- Optimized LED performance show no visual flicker
- Built-in voltage surge and lightning protection
- The Dome designed with no negative slope in front of the prism

### INSTALLATION

Light fixture can be installed in 12-inch Shallow Base & Deep Base.

*\*refer to the user manual DC-MN-IN-12*

### ENVIRONMENTAL CONDITIONS

- **Temperature:** -45 °C to +55 °C  
-49 °F to +131 °F
- **Humidity:** Up to 100%

### DIMENSIONS & WEIGHT

- **Diameter:** 304 mm
- **Depth:** 106mm
- **Weight:** 8.9 kg

### COMPLIANCE With

<b>ICAO</b>	Annex 14 - Volume I
<b>EASA</b>	CS-ADR-DSN
<b>FAA</b>	L-850A-T(L) AC150/5345-46 and EB No.67
<b>IEC</b>	TS 61827
<b>NATO</b>	STANAG 3316
<b>CAA</b>	CAP 168
<b>IAAE</b>	TP312

### APPLICATIONS

- Runway Centerline
- Rapid Exit Taxiway Indicator (RETIL)

### FEATURES & BENEFITS

- LED Bidirectional 12"
- LED lamp's lifespan depending on operating conditions is about 50,000 to 100,000 hours or 5 to 10 years.
- Low energy consumption compare to the Halogen types, which means lower loads, lower range of CCRs and transformers.
- Operates on 3 or 5 steps ferroresonant or thyristor CCRs are in compliance with IEC or FAA standards.
- Full compatibility with existing airfield lighting infrastructure. Installation on same mounting device as most conventional lights, for a straightforward replacement.
- IP68: Dust-tight & protected against submersion in water
- Designed with few mechanical parts which make it easier, cheaper and allowing longer intervals to maintenance

#### COMPONENTS

- 1 : Dome ( Upper Cover )
- 2 : O-Ring for dome
- 3 : O-Ring for lower cover
- 4 : Prism
- 5 : Prism Gasket
- 6 : Prism Holder
- 7 : Prism Holder Gasket
- 8 : Optical Lens
- 9 : LED module
- 10 : Heat Sink
- 11 : Lower cover with electronic
- 12 : Cable Gland
- 13 : Valve for watertightness test
- 14 : Plug

\*Refer to the user manual DC-MN-IN-12

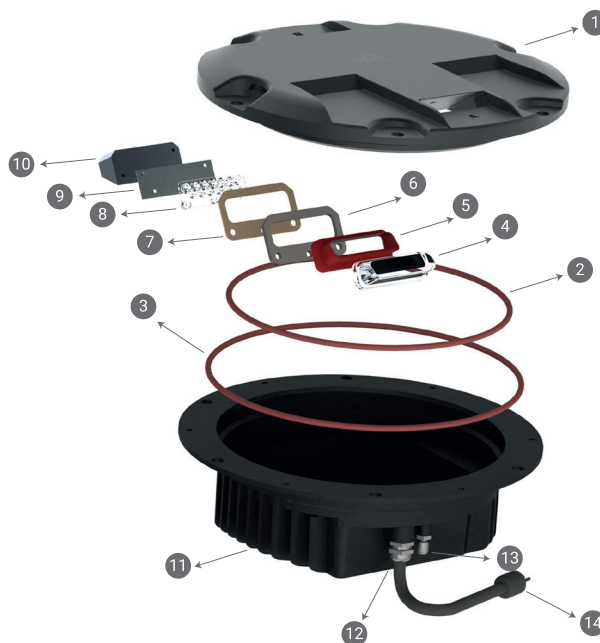

#### PHOTOMETRIC PERFORMANCE

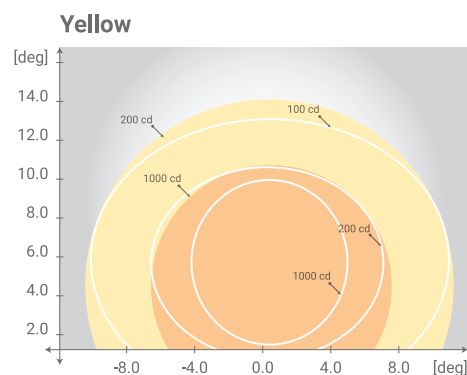
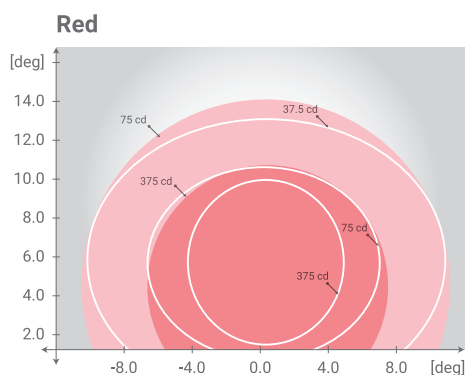
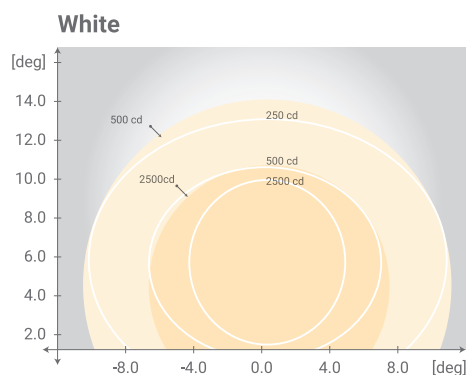

#### INSTALLATION SECTION

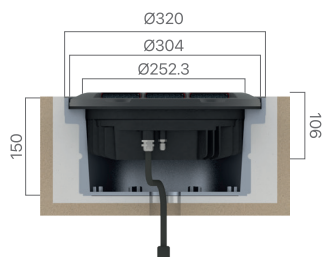

Shallow Base 12"

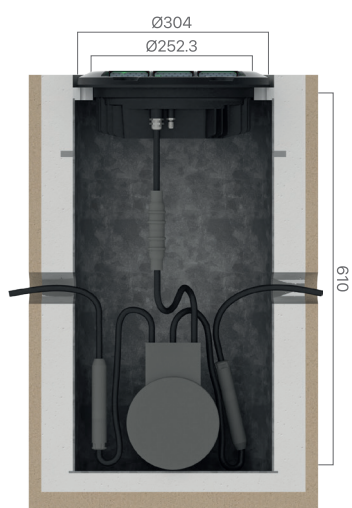

Deep Base 12"

#### ELECTRICAL TABLE

TYPE	Consumption at 6.6A		Power Factor	
	1 Plug	2 Plugs	2.8A	6.6A
Unidirectional (w/o Heater)	20 VA	-	0.96	0.98
Unidirectional (with Heater)	60 VA	-	0.96	0.98
Bidirectional (w/o Heater)	31 VA	40 VA	0.96	0.98
Bidirectional (with Heater)	71 VA	120 VA	0.96	0.98

IN-RL RC WW 1P M H

12" Inset Light Type For **Runway Centerline**

#### Application

- **RC** : Runway Centerline
- **ET** : Rapid Exit Taxiway Indicator (RETIL)

#### Color ( A Side / B Side )\*

- **W** : White
- **G** : Green
- **R** : Red
- **Y** : Yellow
- **0** : None ( Unidirectional )

#### Cable & Connectors

- **1P** : One Plug
- **2P** : Two Plugs

#### Monitoring

- **M** : with Monitoring
- **Q** : without Monitoring

#### Heater

- **H** : with Heater
- **C** : without Heater



Frauenlobstraße 8  
60487 Frankfurt am Main/Germany  
**P.O.Box** 60442  
900220 Frankfurt am Main/Germany

**Tel** +49 69 970 863 97  
**Fax** +49 69 70 797 804  
**Email** [info@aviasafe.de](mailto:info@aviasafe.de)  
**Web** [www.aviasafe.de](http://www.aviasafe.de)

